



**8601 SOMERSET** provides up to 70,900 square feet of fully conditioned and sprinkled, high tech industrial space. Our location in central Pinellas County provides easy access to this vibrant market and high quality labor pool.

We are located in Largo just off Starkey Road, a major north-south artery. This location between Ulmerton and Brian-Dairy roads provides easy access to throughout Pinellas County as well as quick access to the interstate system.

# 8601 SOMERSET Hi-Tech Industrial Facility

## DETAILS



### Contact:

Workman Properties at 727-461-5666

- Excellent mid Pinellas location off Starkey Road
- Can be subdivided – from 10,000 sf to 70,950 sf available
- Entire facility is air conditioned & heated
- Ceiling heights up to 29'
- Substantial office buildout in place
- Heavy 3 phase power in place
- Lighting in place for detailed assembly operations
- Ample parking
- FDA certified facility
- Dock high and grade level loading
- Facility is fully sprinkled

# HI-TECH INDUSTRIAL FACILITY

## 8601 Somerset

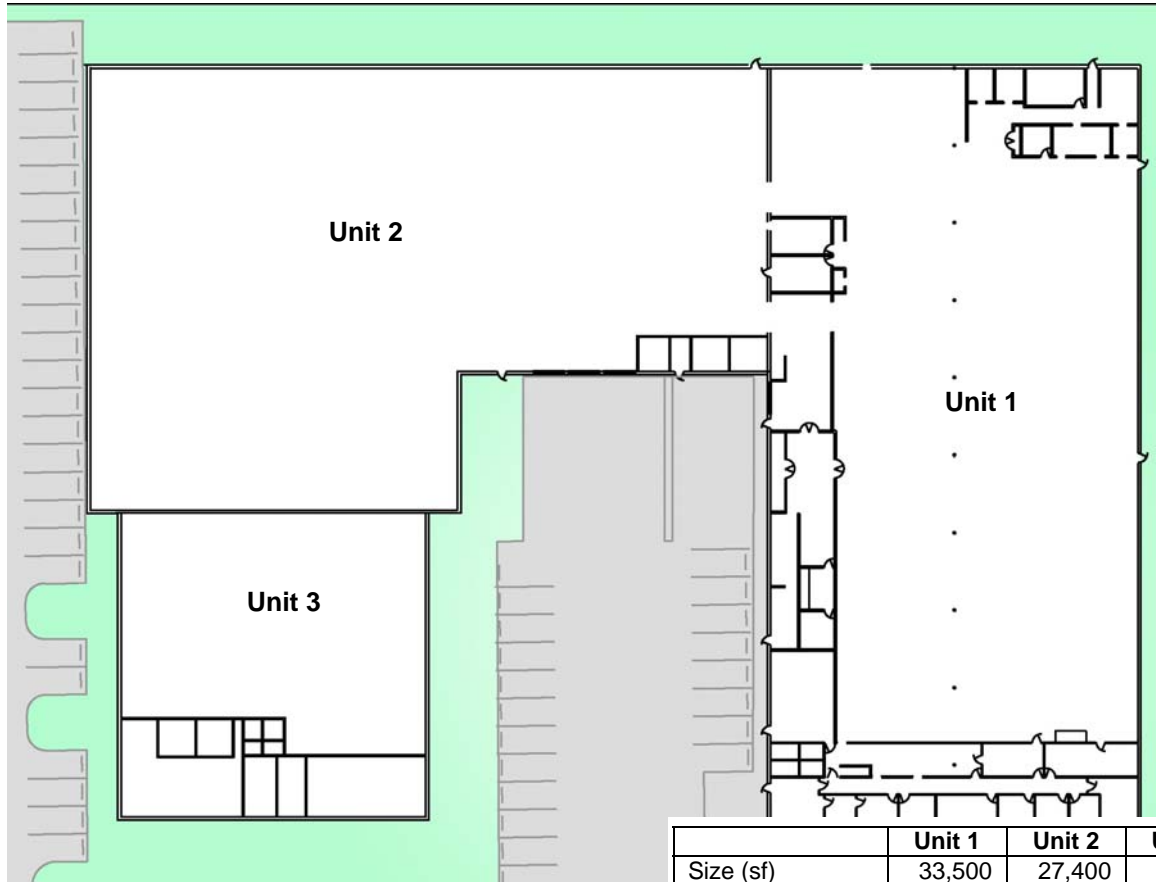

	Unit 1	Unit 2	Unit 3
Size (sf)	33,500	27,400	10,000
Type space	Office/ Assy.	Whse	Office/ Wse
Sprinkled	Yes	Yes	Yes
Air Conditioned	Yes	Yes	Yes
Offices (sf)	6,500		1,950



Unit 1 - Assembly Area

